

A NOTARIAL CERTIFICATE

State of Kentucky, ss. County of Kenton. On this day personally appeared before me a Notary Public in and for said county and state G.W. McMillan and Lessie McMillan personally known to me, and known to be Trustees for the Florida Development Association and respectively President and Secretary of said Association, who thereupon executed the instrument next below, and then and there, each being by me duly sworn, did depose and acknowledge before me that they each respectively executed the said instrument above described, for the use and purpose therein expressed.

PLAT BOOK # 1 PAGE # 21



TOWNSITE DRAWING MARGARET BAKER COUNTY FLORIDA SECTION 5-3-21

OFFICIAL DEDICATION

KNOW ALL MEN BY THESE PRESENTS: THAT G.W. McMillan and Lessie McMillan, as Trustees and as President and Secretary respectively, of the Florida Development Association and the owners in fee of all N.E. 1/4 in Section Five (5), north of R.R. and of the W. 1/2 of the N.W. 1/4 of Section Four (4), all in Township Three (3) E. and Range Twenty-one (21) S. in the county of Baker and in the State of Florida, do hereby dedicate unencumbered certain streets, alleys and Public grounds as indicated in the accompanying Townsite Map of Margaretta for public use, and in like manner they assign for sale to the public, in the manner provided by the laws of the State for the conveyance of real estate, all the lots in 64 Blocks, as indicated by numbers in the town map of Margaretta.

IN WITNESS WHEREOF I have hereto set my hand and affixed my official seal on this second day of January, A.D. 1925. My Commission expires on January 15, 1928.

SIGNATURES: G.W. McMillan President & Trustee, Lessie McMillan Secretary & Trustee.

ENGINEER'S CERTIFICATE

This is to certify that the Townsite Drawing of Margaretta indicates actual surveys and the plat has been made in accordance with said surveys, by the undersigned as the official Engineer by the authority of the officials of the Florida Development Association. The following is a general outline of the town plat, beginning at the northeast corner of the southeast corner of the S.W. 1/4 S.W. 1/4 of Section 33-2-21; thence W 1294 feet to the N.E. corner of Section 5-3-21; thence W 175 feet; thence on the north side of 7th Street S 79° E 2520 feet to the northwest corner of the townsite; thence S 11° E 2180 feet to the north line of the Florida No. 1 Highway; thence with said line N 79° E 3700 feet to the E line S.W. 1/4 S.W. 1/4 Section 4-3-21; thence 1963' plus north to the place of beginning containing approximately 200 Acres, being and lying in part in the four quarters of Section 5-3-21, and in the W 1/2 of Section 4-3-21, all in Baker County, State of Florida.

Signature of Engineer: James W. Jones

See special drawing for width of front sidewalk, highway, boulevard and railroad.

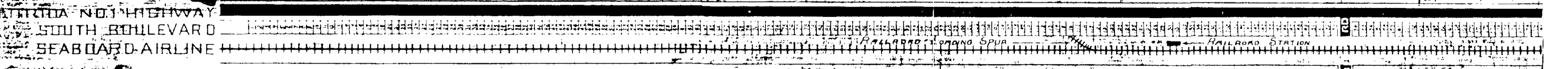
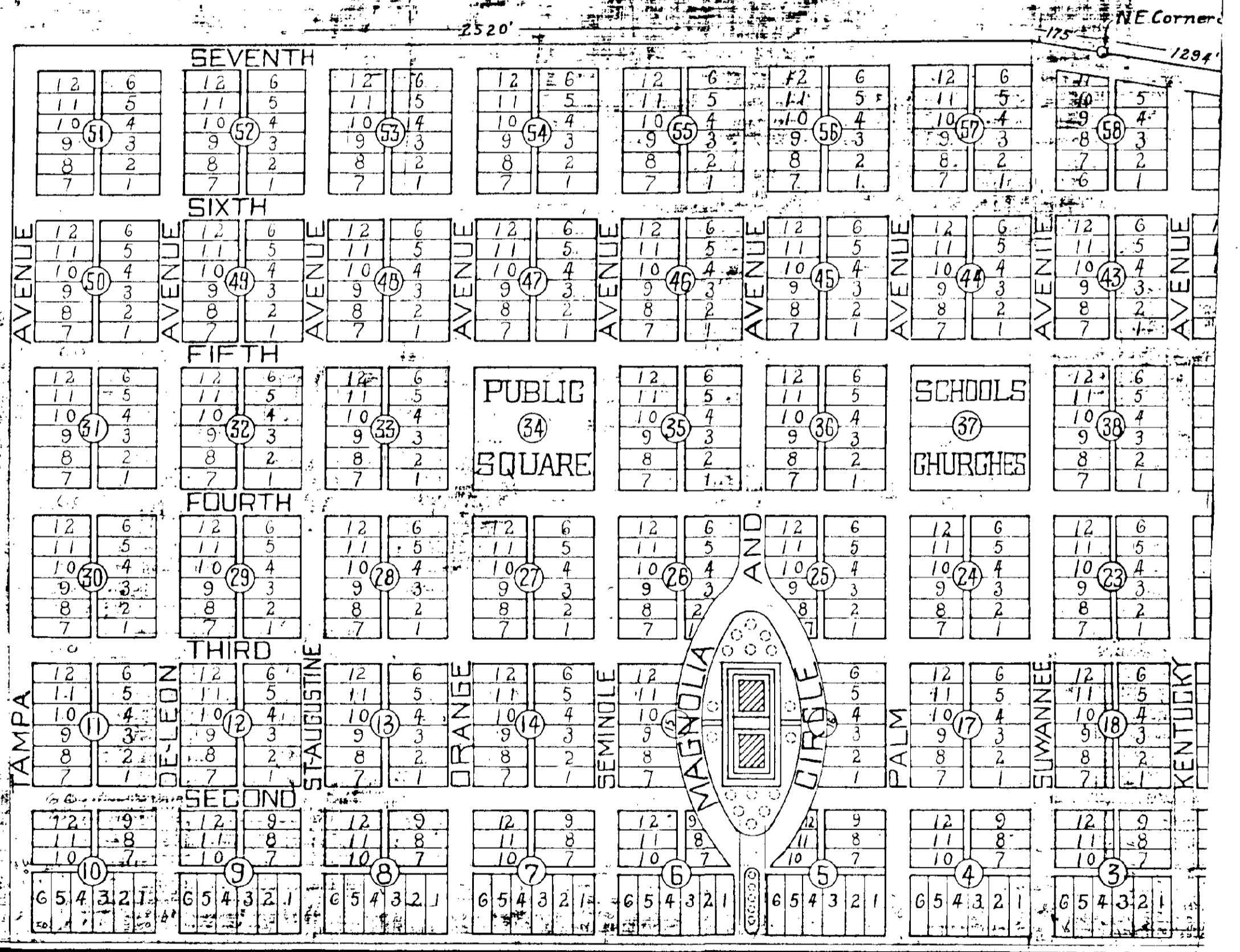

JENKINS, W. JONES ENGINEER CINCINNATI, OHIO